

# PORCH-LIFT<sup>®</sup>

VERTICAL PLATFORM LIFT

Residential  
Lift

## Unit Dimensional Drawing

### STANDARD EQUIPMENT

Platform Control Switch with Emergency Stop, Key Operation  
 All Controls – constant pressure  
 Low Voltage Controls- 24 Volt  
 Platform Safety Pan  
 36" high Platform Guard Panels  
 36" x 48" Platform with Non-skid Surface  
 15-1/2" long Automatic Folding Access Ramp  
 550 lb. Capacity  
 Ivory White Powder Coat Finish  
 UL Listed when appropriately equipped  
 3/4 HP Motor, 120 V, 60 Hz  
 Acme Screw Drive  
 Three V-Belt Drive System with Monitoring Device  
 ASME/ANSI A18.1 (formerly A17.1: Part XX, Section 2100 for private residences) when appropriately equipped with Options.

### OPTIONAL EQUIPMENT

42" high Top Landing Gate  
 Access ESI (doors & gates by others)  
 Flush Mount Electric Strike (door/gate by others)  
 Keyed Dead Latch (for use with Flush Mount Electric Strike)  
 Fascia Panel, 36" wide  
 Manual Lowering Device  
 Optional Colors

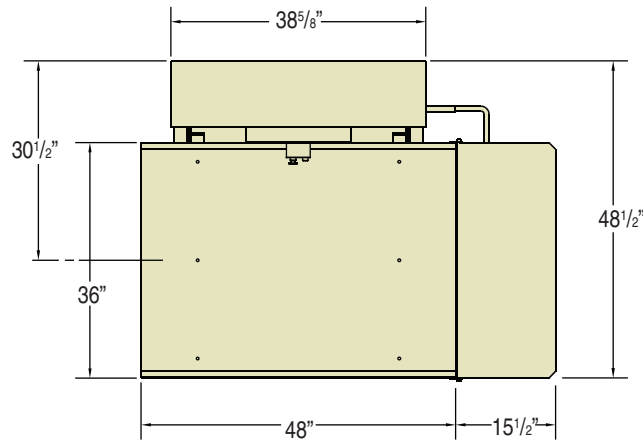

PLAN VIEW

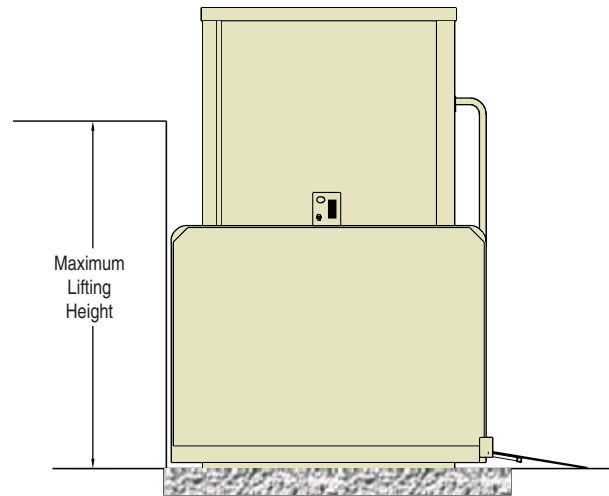

FRONT ELEVATION

Model PL-RA		
Model	Max. Lifting Ht.	Tower Height
24	27"	47 1/4"
36	39"	62 1/4"
50	53"	73 1/4"
72	75"	95 1/4"

“STOCK UNIT” – Right hand configuration (shown)(can be changed in field) and has all the Standard Equipment listed and no Options.

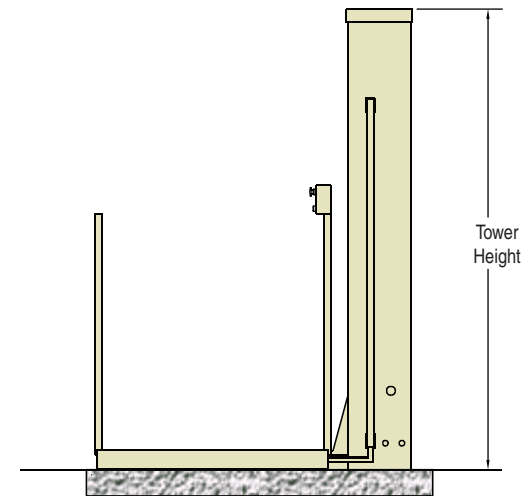

LOWER LANDING  
SIDE ELEVATION

**Note:** 4" thick, 3500 PSI, reinforced concrete slab required.

4001 East 138th Street  
 Grandview, MO 64030-2837  
 Phone: 816-763-3100  
 Fax: 816-763-4467  
 Toll Free: 800-925-3100  
 www.tkaccess.com

**ThyssenKrupp Access**

Accessibility Division



ThyssenKrupp